



Alfa Laval MultiMagnum is a rotary tank washing head that allows impact washing. Since the device uses little amounts of cleaning fluid at low pressure, it offers an alternative to conventional washing heads. Alfa Laval MultiMagnum rotary heads have a double ball seat, which allows the washing head to operate in all directions; and it fit for use in all cleaning applications including tanks with a volume from 5 to 50 m³ as well as reactors and containers. Dimensions/options are available in the CAS program which is used for tank cleaning equipment of Alfa Laval.

OPERATION PRINCIPLE

The flow of the cleaning fluid rotates the Alfa Laval MultiMagnum head, and shaped jets create a pattern that turns like a vortex everywhere inside the tank or reactor. This creates the impact that is required to eliminate residual materials, and the gradual flow covers all internal surfaces of the tank.

Materials

Input Connections	1.4401(316L)
Seat Components	Duplex (UNS31803)
Balls	1.4401(316)
Heads	1.4404(316L)

Technical Data

Weight.....	Threaded: 0,90kg
Maintenance	Self-lubricating with cleaning fluid
Operating pressure	1-3 bar
Recommended pressure.....	2 bar
Maximum Operating Temperature	95 °C
Maximum Ambient Temperature	140 °C
Wetting Radius	Max. 3m
Impact Cleaning Radius	Max. Effective 2 m
Fittings	1 1/4" BSP Threaded Thread Connection

Spray Pattern

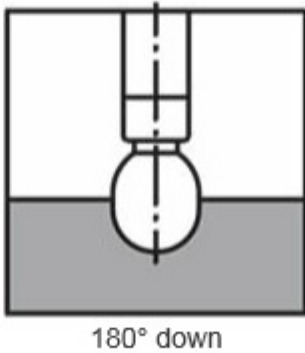
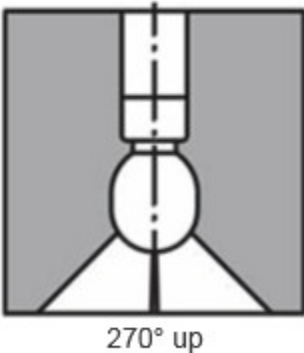
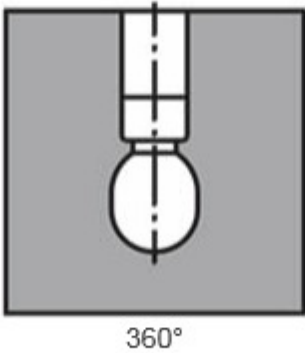

Flow Rate

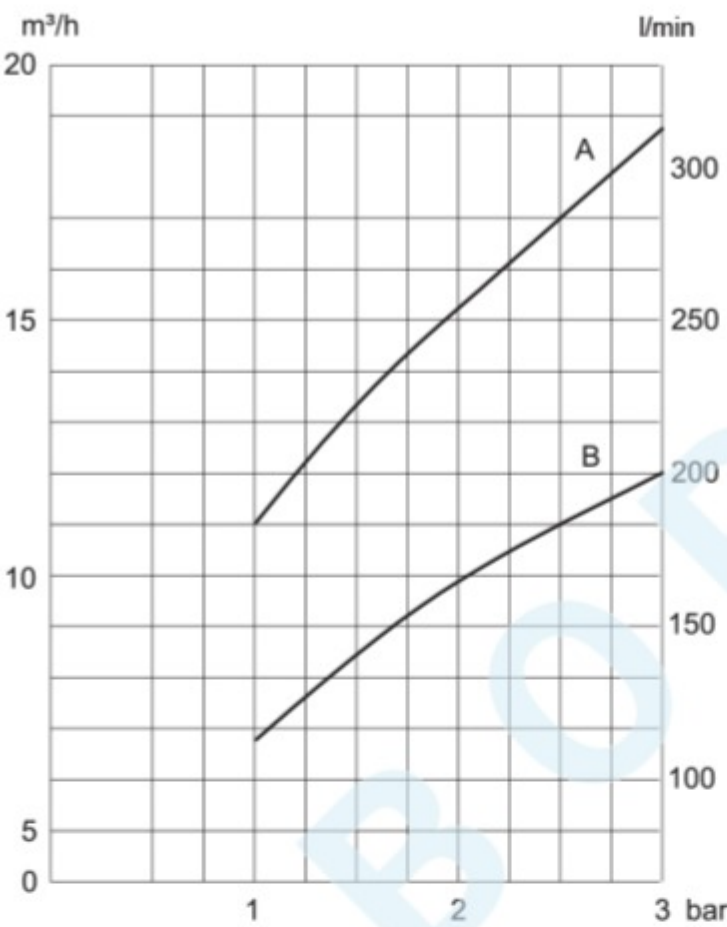

Input pressure

Cleaning Radius

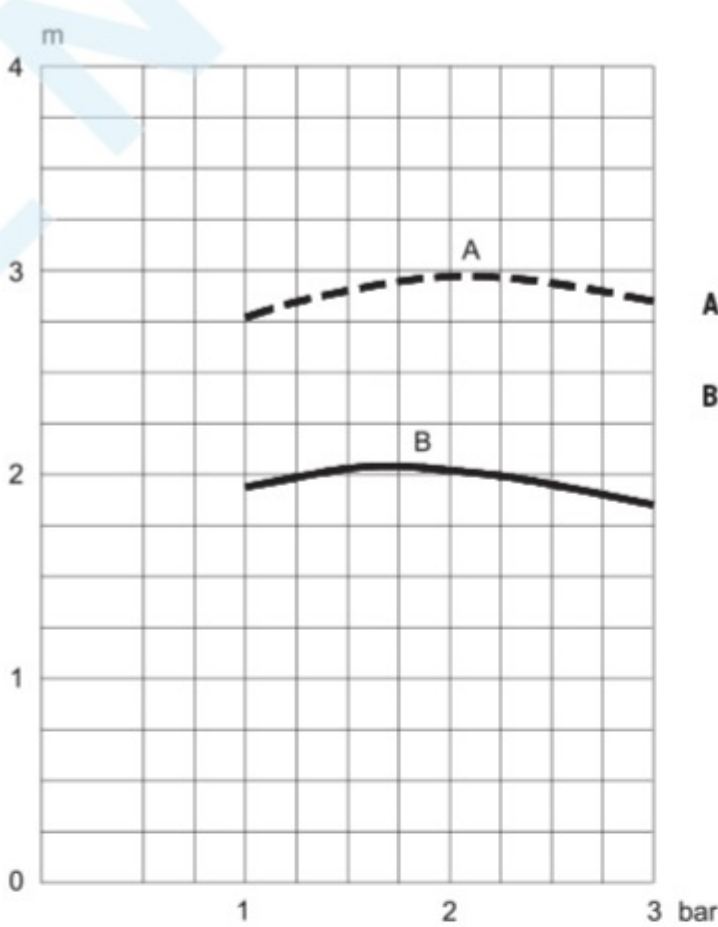

Input pressure
A: Wetting - B: Impact cleaning

Note: Flow rate has been increased by approximately 1.5 m³/h for clipped models.

Dimensions (mm)

Threaded

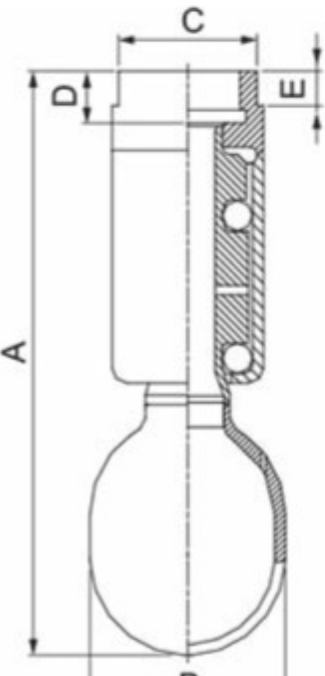

Welded

